

# Grade Rod Parts List

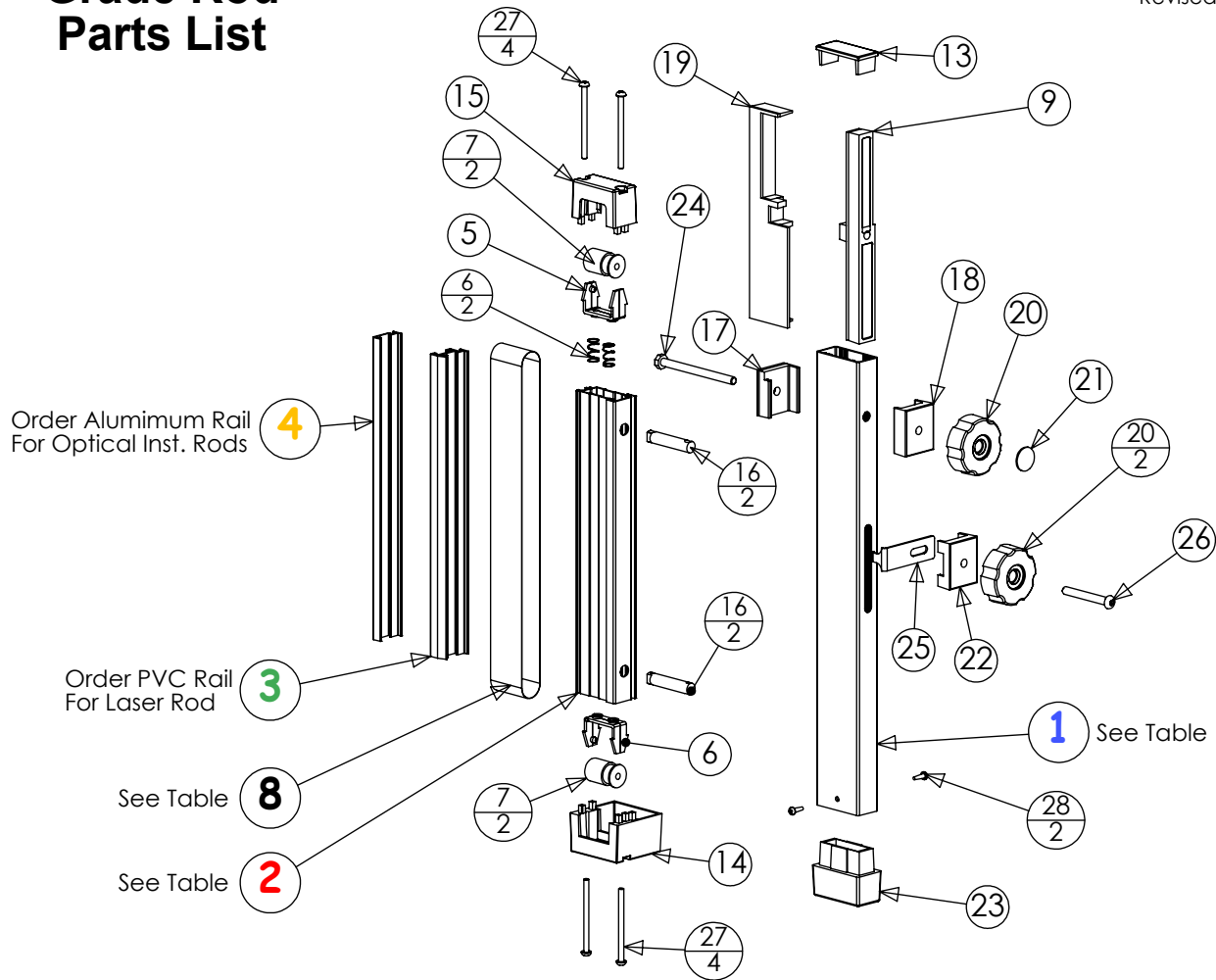

### Tape Configurations

Tapes (Item 4)

Rod	Part Number	Description
10ft	1000-1023	10ths/Cut & Fill
10ft	1000-1026	10ths Full Face
10ft	1000-1036	Inches/Cut & Fill
10ft	1000-1037	Inches/10ths
10ft	1000-1038	Inches Full Face
15ft	1000-1501	10ths/Cut & Fill
15ft	1000-1504	10th Full Face
3M	1000-1024	Metric Full Face
3M	1000-1035	Metric/Cut & Fill
5M	1000-1502	Metric Full Face
5M	1000-1503	Metric/Cut & Fill

### BOM Table

Item	PART NUMBER	DESCRIPTION	QTY
1	1000-1020-(X)	Housing, Rear Rod (See Table)	1
2	1000-1021-(X)	Housing, Front Rod (See Table)	1
3	1000-1022-(X)	Rail, Black PVC (See Table)	1
4	1000-1032-(X)	Rail, Aluminum (See Table)	1
8	See Table	Tape- See Tape Configuration Table	1
5	1000-1011	Support, Roller	2
6	0000-1217	Spring, od .360 id .310 wire .026	2
7	1000-1018	Roller, Tape	2
9	1000-1014	Slide Assy. Tape Lock Right	1
13	1000-1002	Cap, Rear Rod Top	1
14	1000-1001	Cap, Front Rod Bottom	1
15	1000-1000	Cap, Front Rod Top	1
16	1000-1019	Dowel, Frnt Rd Top/Bottom Caps	2
17	1000-1005	Clamp, Rod Lock (Left)	1
18	1000-1004	Clamp, Rod Lock (Right)	1
19	1000-1008	Slide, Left Tape Lock	1
20	1000-1015	Knob, Locking	2
21	Supplied with Knob	Cover, Rod Lock Knob Only	1
22	1000-1012	Guide, Tape Lock Pin	1
23	1000-1003	Foot, Rear Rod	1
24	0000-1600	Bolt, 1/4-20 X 3.5 HXHD	1
25	1000-1013	Pin, Tape Lock	1
26	0000-1604	Screw, 1/4-20 X 2" BH SS	1
27	0000-1089	Screw, 8-32 X 2.5 PH PH	4
28	0000-1180	Screw #6 Machine	2

### Housing & Rail Configurations

Rod	Rear Housing	Front Housing	Laser Rail PVC	Survey Rail Alum.
10ft	1000-1020-10	1000-1021-10	1000-1022-10	1000-1032-10
15ft	-15	-15	-15	-15
3 M	-3	-3	-3	-3
5 M	-5	-5	-5	-5